



Also Available
Optional Keyways
Custom Bores Sizes
Plastic Universal Joints

UNIVERSAL JOINTS - PRECISION NEEDLE ROLLER

Steel 35SMnPb10, Bearing Parts 18NiCrMo5Pb. The needle-bearing universal joints have almost zero backlash, high accuracy and good turning properties. These special needle-rollers without cage can take high loads even at large operating angles. A special grinding process realizes a perfect parallelism of the axes and the single parts of the joints - which guarantees an extremely long service

SINGLE

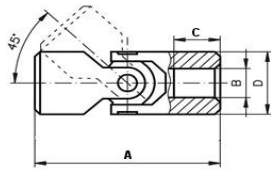

SIZES IN MM

PART#	B - H7	D	A	C	Permissible max. Torques in Nm at different speeds						Weight (kg)
					min -1						
					250 (Nm)	500 (Nm)	1000 (Nm)	2000 (Nm)	3000 (Nm)	4000 (Nm)	
UR8S	8	16	52	15	5,8	5,8	5,8	5,8	x	x	0,05
UR10S	10	20	62	18	22	17	14	11	10	9	0,10
UR14S	14	25	74	20	34	29	24	22	20	18	0,18
UR16S	16	32	86	24	65	55	45	40	37	32	0,33
UR18S	18	37	72	17	75	61	50	45	40	36	0,40
UR20S	20	40	108	30	140	120	100	80	70	65	0,71
UR25S	25	50	132	38	200	170	130	110	90	85	1,33
UR30S	30	63	166	45	300	270	230	190	160	140	2,78
UR35S	35	70	140	35	326	277	237	198	168	x	2,75
UR40S	40	80	180	50	365	303	255	205	186	x	4,93

Max. Operating Angle 45°.

DOUBLE

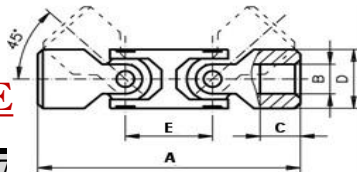

PART#	B - H7	D	A	C	E	Permissible max. Torques in Nm at different speeds						Weight (kg)
						min -1						
						250 (Nm)	500 (Nm)	1000 (Nm)	2000 (Nm)	3000 (Nm)	4000 (Nm)	
UR16D	10	20	88	26	18	19,8	15,3	12,6	9,9	9	8	0,14
UR14D	14	25	104	33	20	30	26	21	19	18	16	0,24
UR16D	16	32	125	38	24	58	49	40	35	33	28	0,52
UR20D	20	40	156	48	30	125	108	90	70	63	58	1,01
UR25D	25	50	188	56	38	180	150	117	95	80	75	1,63
UR30D	30	63	238	80	42	270	240	207	170	140	125	3,90
UR35D	35	70	212	78	30	293	249	213	178	151	x	4,08
UR40D	40	80	290	120	48	328	272	230	185	167	x	7,96

Max. Operating Angle 90°.