

MODEL	RATED TORQUE @ STD. AIR GAP		BREAKAWAY TORQUE		MAX RPM
MDC 1	1.0 Nm	9 Lb-in	1.4 Nm	12 Lb-in	19000

REVISIONS			
REV.	ECN.	DESCRIPTION	DATE

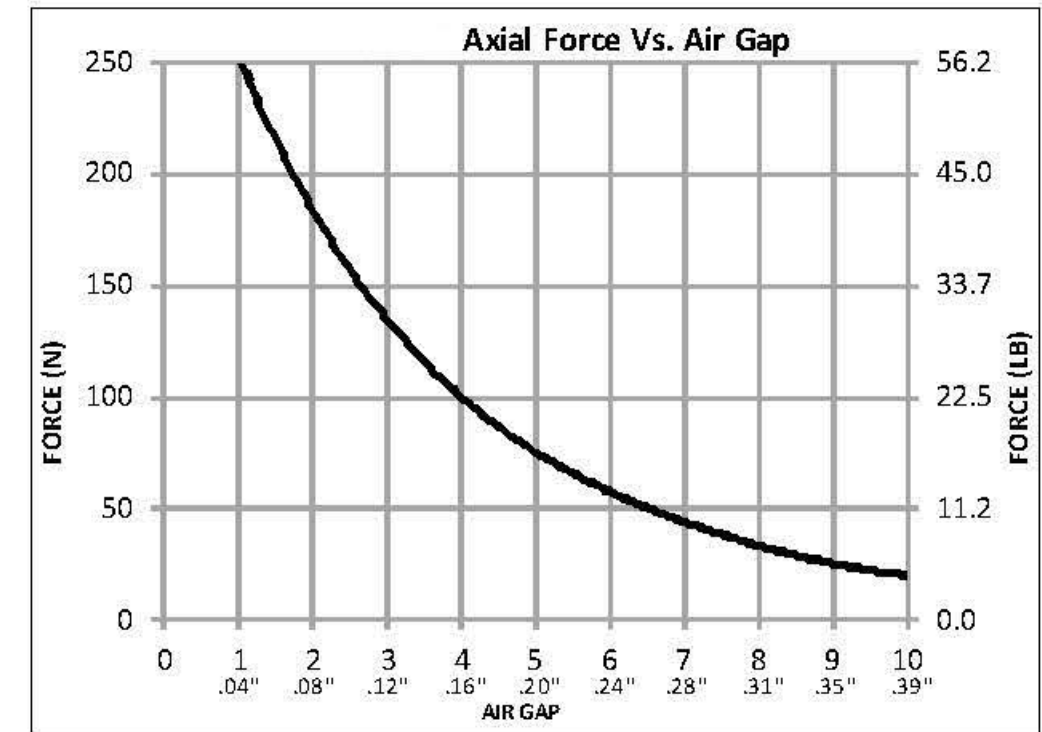
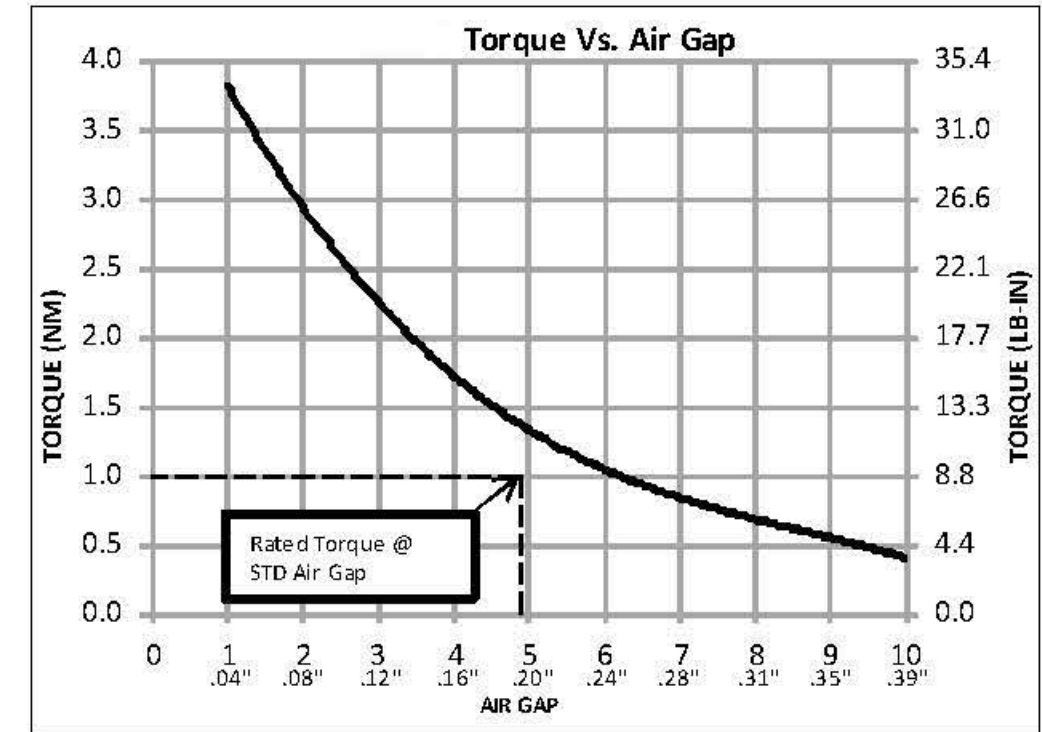
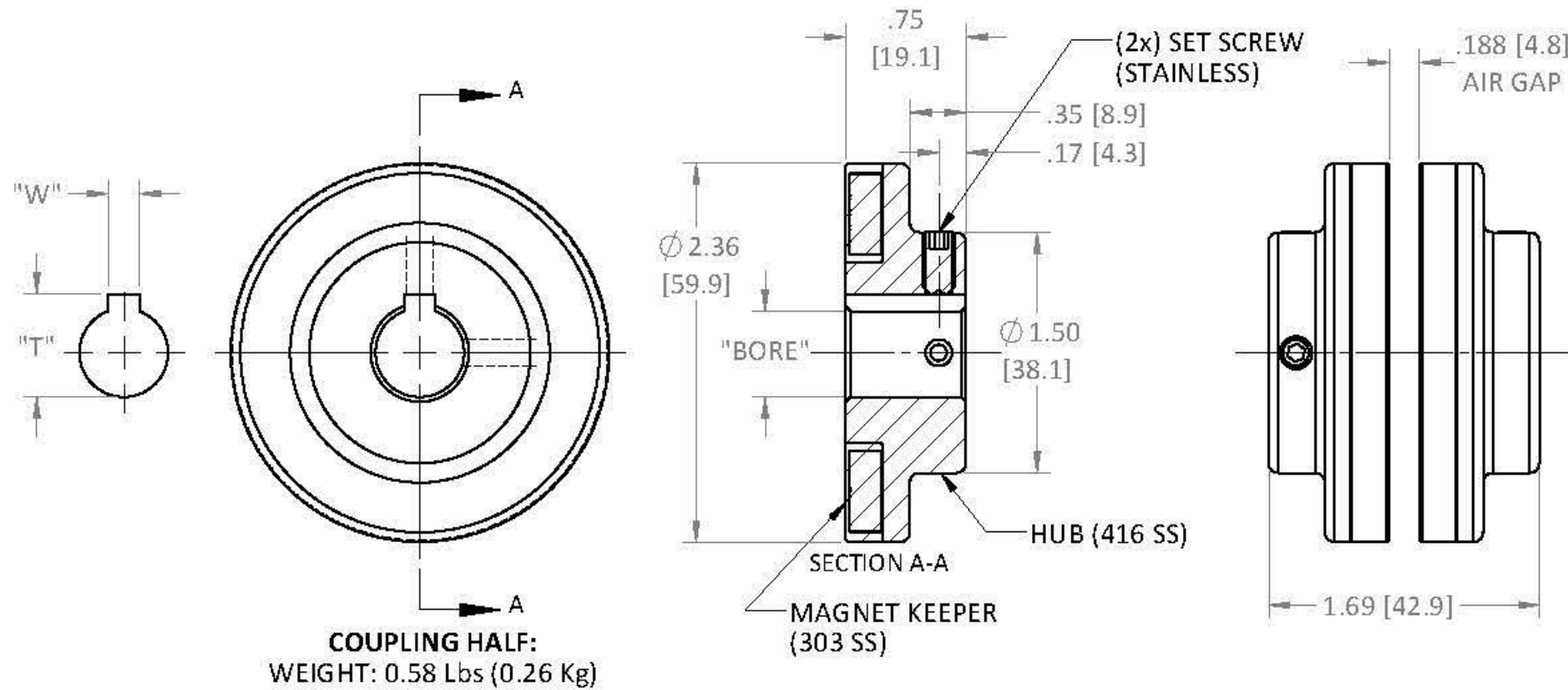

MODEL	BORE		W		T		SET SCREW (2x)
MDC 1	mm ^{H8}	in ⁺⁰⁰¹	mm ⁺⁰⁵	in ⁺⁰⁰²	mm ⁺²⁵	in ⁺⁰¹⁰	CUP POINT
	SOLID		-	-	-	-	-
	9.53	.375	-	-	-	-	#10-32 x 3/8
	10.00	.394	-	-	-	-	M5-0.8 x 10 mm
	11.00	.433	4.00	.158	12.80	.504	M5-0.8 x 10 mm
	12.00	.472	4.00	.158	13.79	.543	M5-0.8 x 10 mm
	12.70	.500	3.18	.125	14.22	.560	#10-32 x 3/8
	14.00	.551	5.00	.197	16.31	.642	M5-0.8 x 10mm
	15.88	.625	4.76	.188	18.01	.709	#10-32 x 3/8
	18.00	.709	6.00	.236	20.80	.819	M5-0.8 x 10 mm
	19.00	.748	6.00	.236	21.79	.858	M5-0.8 x 10 mm
	19.05	.750	4.76	.188	21.26	.837	#10-32 x 3/8

OTHER SIZES AVAILABLE; SPECIFY BOTH BORE AND KEYWAY

USED ON	SCALE 1:1	MATERIAL SEE PRT DWG
UNLESS OTHERWISE SPECIFIED:		FINISH SEE PRT DWG
ALL DIMENSIONS ARE IN INCHES TOLERANCES: DECIMAL: JX ± .01 - JXXX ± .005 ANGULAR: ± 1° GEN. CONCENTRICITY: .001 T.I.R. MACH. FILLETS: .010 R MACH. EDGES: .015 R OR CHMF. UNSPECIFIED RADII: .015 R IN MICROINCHES RMS 32 GEOMETRIC: TO MIL-ST'D. 8 REMOVE ALL BURRS & SHARP EDGES		DRAWN AMD 10/17/14 CHECKED DESCRIPTION DWG. NO. REV.
SIZE: B		