

MODEL	RATED TORQUE @ STD. AIR GAP		BREAKAWAY TORQUE		MAX RPM
MDC 20	20.3 Nm	180 Lb-in	22.0 Nm	195 Lb-in	9,200

REVISIONS			
REV.	ECN.	DESCRIPTION	DATE

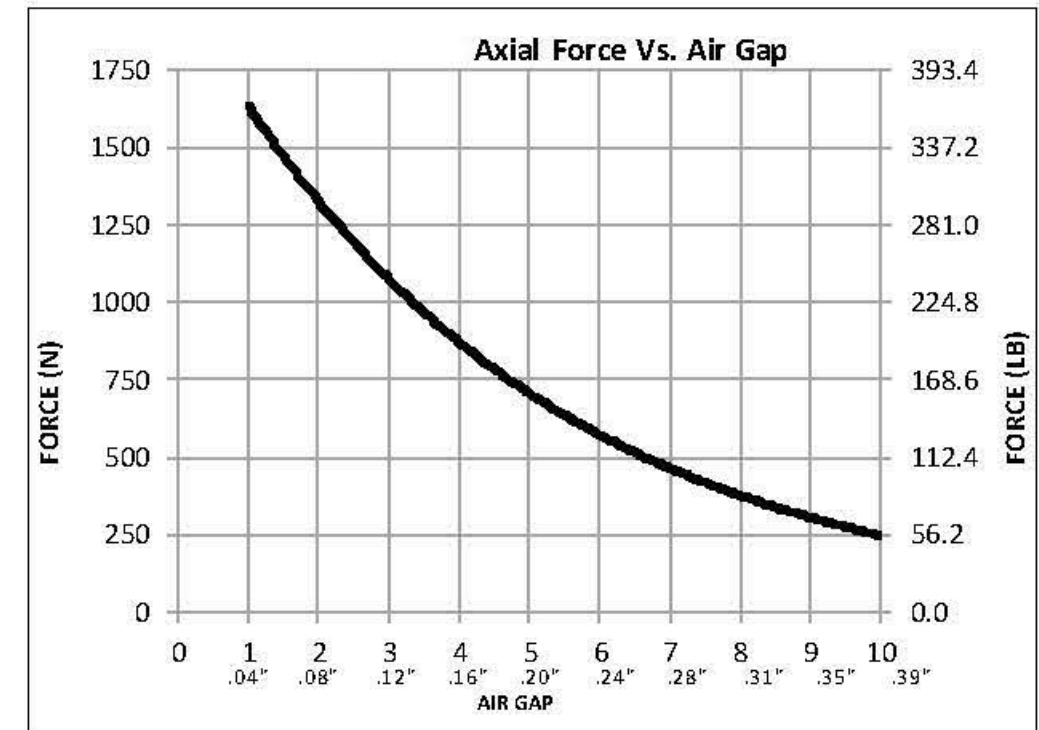
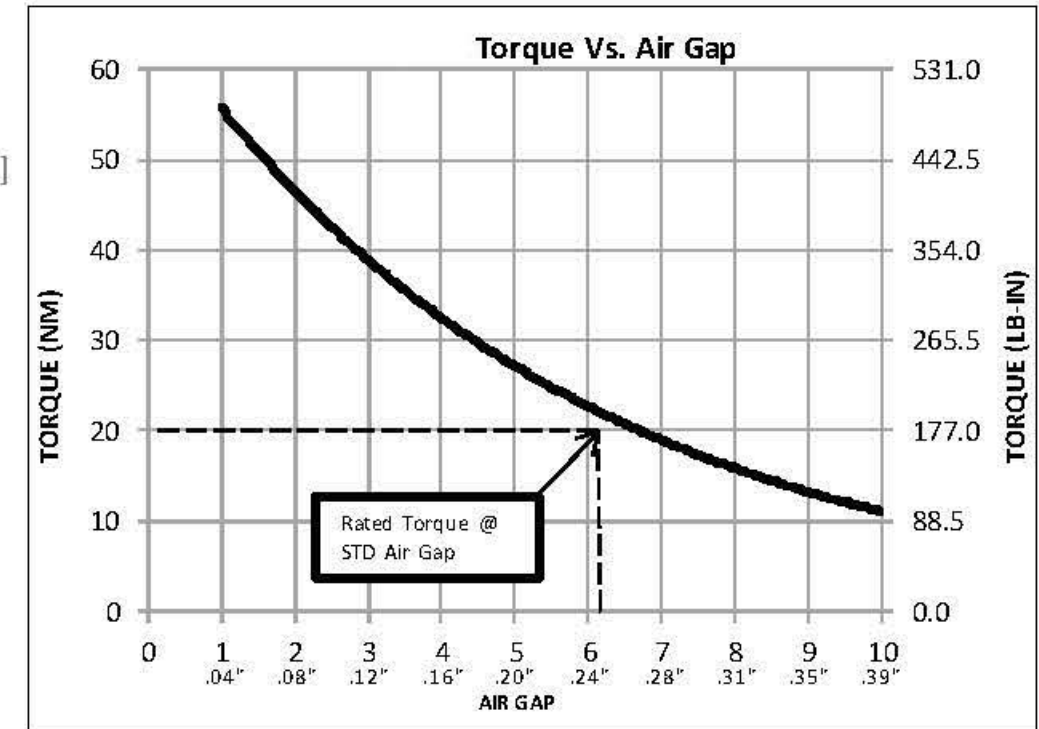
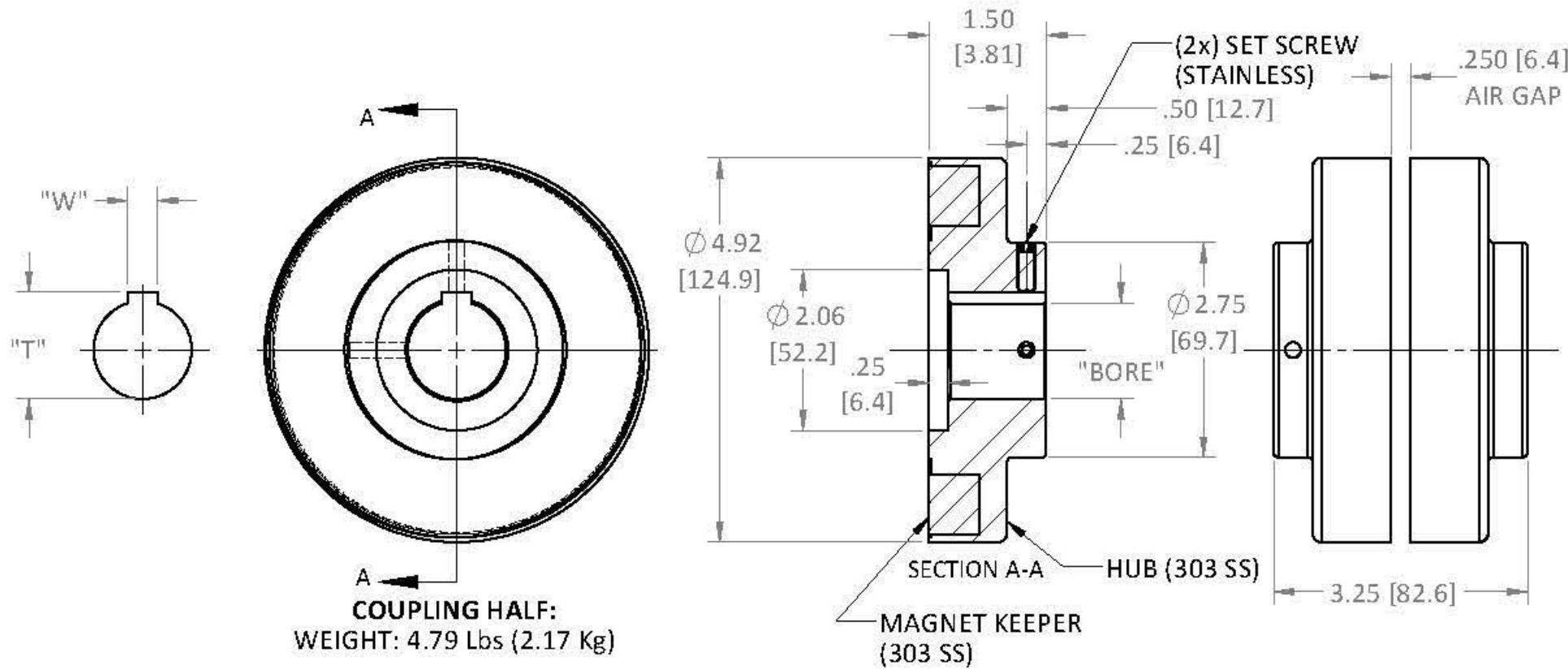

MODEL	BORE		W		T		SET SCREW (2x)
	mm ^{H8}	in ⁺⁰⁰¹	mm ⁺⁰⁵	in ⁺⁰⁰²	mm ⁺²⁵	in ⁺⁰¹⁰	
MDC 20							CUP POINT
	SOLID		-		-		-
	19.05	.750	4.76	.1875	21.26	.837	10-32 X 3/4
	22.23	.875	-	-	-	-	-
	25.40	1.000	6.35	.250	28.30	1.114	1/4-20 X 1
	28.56	1.125	6.35	.250	31.52	1.241	1/4-20 X 1
	31.75	1.250	6.35	.250	34.72	1.367	1/4-20 X 3/4
	34.93	1.375	7.94	.3125	38.56	1.518	5/16-18 X 3/4
	38.10	1.500	9.53	.375	42.39	1.669	3/8-16 X 5/8
	41.28	1.625	9.53	.375	45.62	1.796	3/8-16 X 5/8

OTHER SIZES AVAILABLE; SPECIFY BOTH BORE AND KEYWAY

*

FROM STOCK

USED ON	SCALE 1:2	MATERIAL SEE PRT DWG	
UNLESS OTHERWISE SPECIFIED:		FINISH SEE PRT DWG	
ALL DIMENSIONS ARE IN INCHES TOLERANCES: DECIMAL: JX ± .01 - JXXX ± .005 ANGULAR: ± 1° GEN. CONCENTRICITY: .001 T.I.R. MACH. FILLETS: .010 R MACH. EDGES: .015 R OR CHMF. UNSPECIFIED RADII: .015 R IN MICROINCHES RMS 32 GEOMETRIC: TO MIL-STD. 8 REMOVE ALL BURRS & SHARP EDGES		DRAWN AMD 11/11/14	DESCRIPTION Cut Sheet
		CHECKED	DWG. NO.
		SIZE: B	REV.