

MODEL	RATED TORQUE @ STD. AIR GAP	BREAKAWAY TORQUE	MAX RPM
MDC 50	53.1 Nm	470 Lb-in	7,800

REVISIONS			
REV.	ECN.	DESCRIPTION	DATE

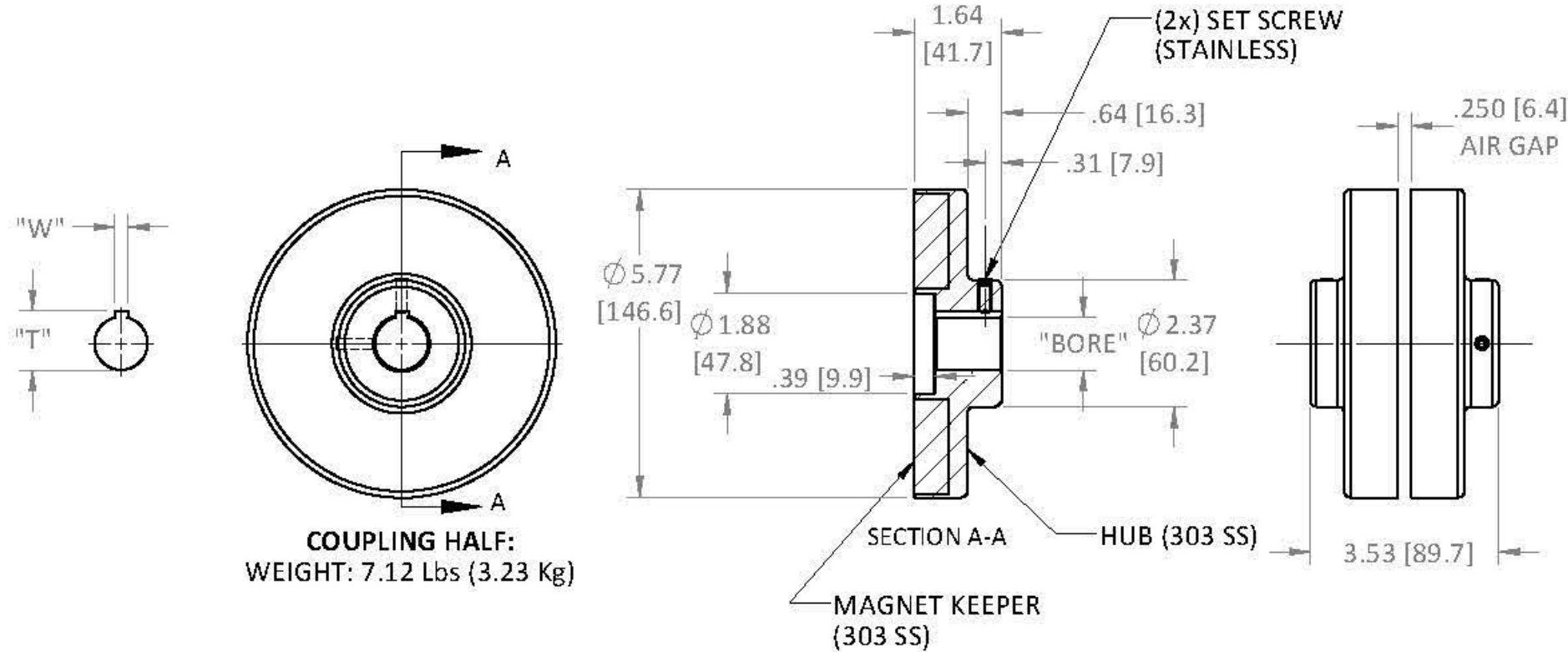

COUPLING HALF:
WEIGHT: 7.12 Lbs (3.23 Kg)

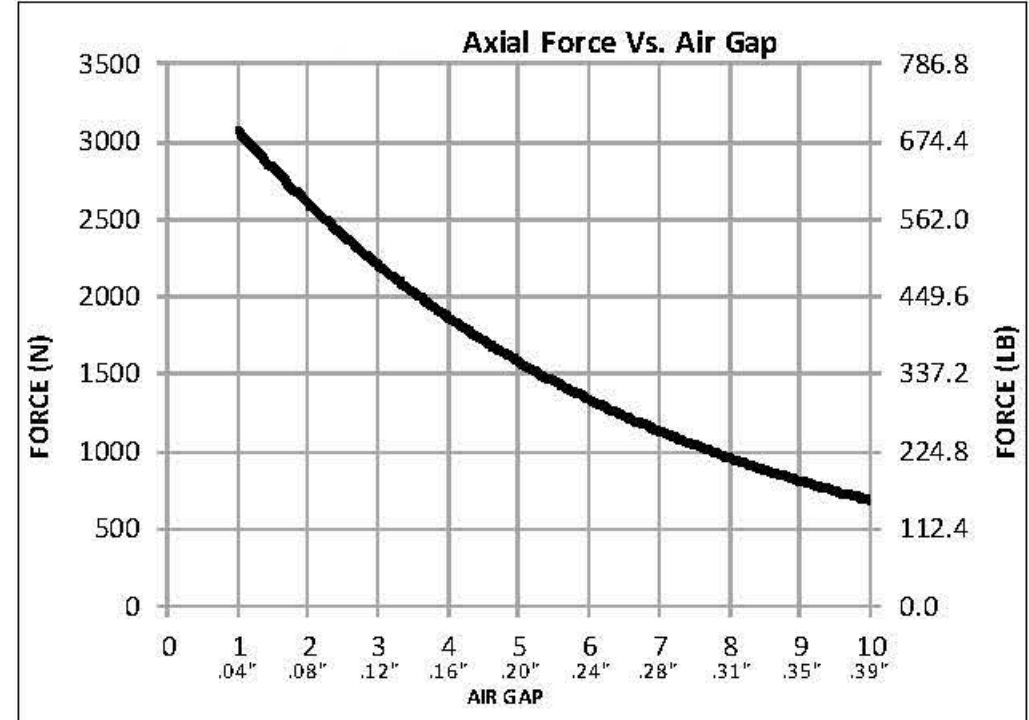
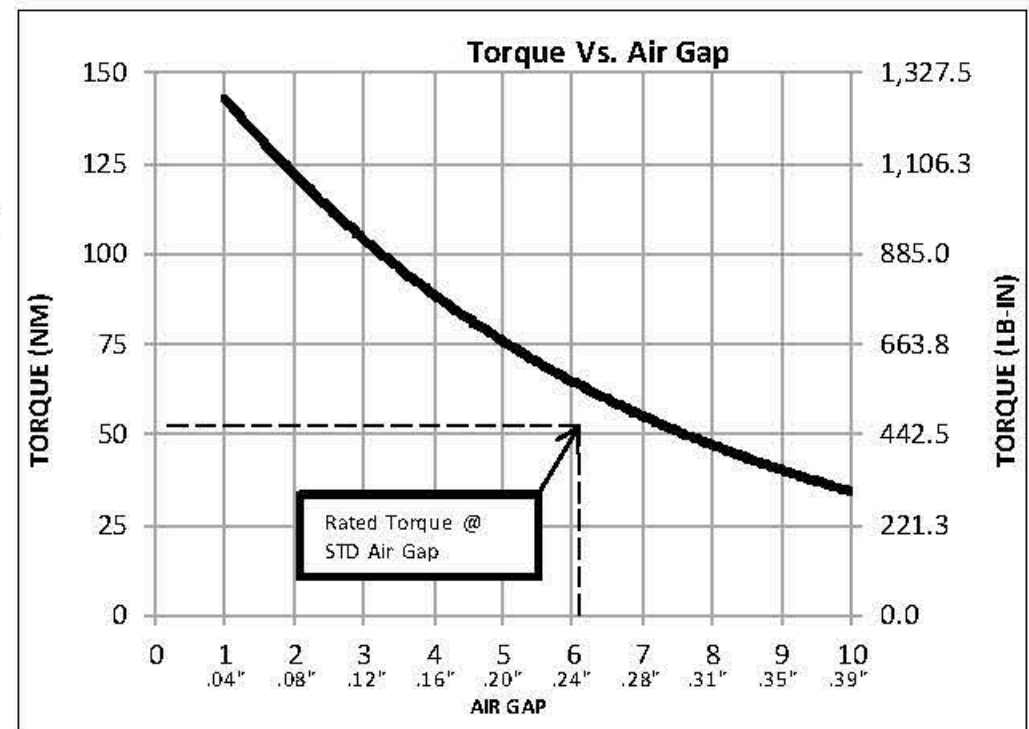

MODEL	BORE		W		T		SET SCREW (2x)
	mm ^{H8}	in ⁺⁰⁰¹	mm ⁺⁰⁵	in ⁺⁰⁰²	mm ⁺²⁵	in ⁺⁰¹⁰	
MDC 50							CUP POINT
*	SOLID		-		-		-
	17.00	.6693	5.00	.197	19.30	.760	M5-0.8 x 16mm
	19.05	.750	4.76	.1875	21.26	.837	10-32 x 1/2
	25.40	1.000	6.35	.250	28.30	1.114	1/4-20 x 1/2
	31.75	1.250	6.35	.250	34.72	1.367	1/4-20 x 3/8
	38.00	1.4961	10.00	.3937	41.30	1.626	M8-1.25 x 8mm

OTHER SIZES AVAILABLE; SPECIFY BOTH BORE AND KEYWAY

*

FROM STOCK

USED ON	SCALE 1:3	MATERIAL SEE PRT DWG
UNLESS OTHERWISE SPECIFIED:		FINISH SEE PRT DWG
<small>ALL DIMENSIONS ARE IN INCHES TOLERANCES: DECIMAL: JX ± .01 - JXX ± .005 ANGULAR: ± 1° GEN. CONCENTRICITY: .001 T.I.R. MACH. FILLETS: .010 R MACH. EDGES: .015 R OR CHMF. UNSPECIFIED RADII: .015 R IN MICROINCHES RMS 32 GEOMETRIC: TO MIL-STD. 8 REMOVE ALL BURRS & SHARP EDGES</small>		
DRAWN AMD 11/11/14	DESCRIPTION Cut Sheet	
CHECKED	DWG. NO.	REV.
SIZE: B		