



## METRIC GEAR RACKS

**MATERIAL:** C45 Steel, and Stainless steel 1.4305

**LENGTHS AVAILABLE:** 1000mm - 3000mm Standard - 20° Pressure Angle - Continuous Mount

SIZES IN MM

PART#	MODULE	H	B	C	LENGTHS AVAILABLE (L)
M1	1	15	15	14	1000 -3000mm
M1.5	1.5	17	17	15.5	1000 -3000mm
M2	2	20	20	18	1000 -3000mm
M2.5	2.5	25	25	22.5	1000 -3000mm
M.3	3	30	30	27	1000 -3000mm
M4	4	40	40	36	1000 -3000mm
M5	5	50	50	45	1000 -3000mm
M6	6	60	60	54	1000 -3000mm
M7	7	80	80	72	1000 -3000mm

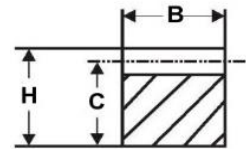
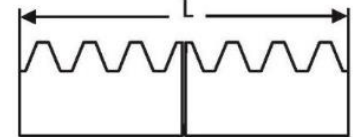

**Also Available**  
**Larger Sizes - Custom Sizes - Plastic Racks - Round Racks**

## ACTUAL TOOTH SIZE



Module 1.0  
Pitch 3.1416



Module 1.5  
Pitch 4.7124



Module 2.0  
Pitch 6.2832



Module 2.5  
Pitch 7.8540



Module 3.0  
Pitch 9.4248



Module 4.0  
Pitch 12.5664



Module 5.0  
Pitch 15.7080



Module 6.0  
Pitch 18.8496