

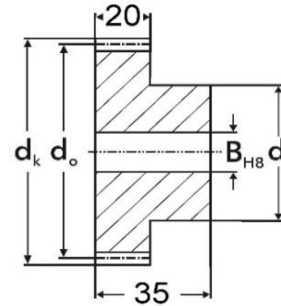

METRIC SPUR GEAR

MODULE 2

MATERIAL: C45 Steel & Stainless Steel 1.4305
C45 Steel Can be Heat Treated
20° Pressure Angle



****ALSO AVAILABLE - PLASTIC, PLATE STYLE & CUSTOM GEARS ****

SIZES IN MM

Part No.	# of Teeth	Bore BH8	Hub Dia d	Outside Dia dk	Pitch Dia do
M2B12	12	10	18	28	24
M2B13	13	10	19	30	26
M2B14	14	10	20	32	28
M2B15	15	10	22	34	30
M2B16	16	10	24	36	32
M2B17	17	10	25	38	34
M2B18	18	10	25	40	36
M2B19	19	10	25	42	38
M2B20	20	10	30	44	40
M2B21	21	12	30	46	42
M2B22	22	12	30	48	44
M2B23	23	12	30	50	46
M2B24	24	12	35	52	48
M2B25	25	12	35	54	50
M2B26	26	12	40	56	52
M2B27	27	12	40	58	54
M2B28	28	12	40	60	56
M2B29	29	14	40	62	58
M2B30	30	14	40	64	60
M2B31	31	14	45	66	62
M2B32	32	14	45	68	64
M2B33	33	14	45	70	66
M2B34	34	14	45	72	68
M2B35	35	14	45	74	70
M2B36	36	14	45	76	72
M2B37	37	14	50	78	74
M2B38	38	14	50	80	76
M2B39	39	14	50	82	78
M2B40	40	14	50	84	80
M2B41	41	16	60	86	82

Part No.	# of Teeth	Bore BH8	Hub Dia d	Outside Dia dk	Pitch Dia do
M2B42	42	16	60	88	84
M2B43	43	16	60	90	86
M2B44	44	16	60	92	88
M2B45	45	16	60	94	90
M2B46	46	16	60	96	92
M2B47	47	16	60	98	94
M2B48	48	16	70	100	96
M2B49	49	16	70	102	98
M2B50	50	16	70	104	100
M2B51	51	20	70	106	102
M2B52	52	20	70	108	104
M2B53	53	20	70	110	106
M2B54	54	20	70	112	108
M2B55	55	20	70	114	110
M2B56	56	20	70	116	112
M2B57	57	20	70	118	114
M2B58	58	20	70	120	116
M2B59	59	20	70	122	118
M2B60	60	20	70	124	120
M2B61	61	20	80	126	122
M2B62	62	20	80	128	124
M2B63	63	20	80	130	126
M2B64	64	20	80	132	128
M2B65	65	20	80	134	130
M2B66	66	20	80	136	132
M2B67	67	20	80	138	134
M2B68	68	20	80	140	136
M2B69	69	20	80	142	138
M2B70	70	20	80	144	140